

# REMOTE ALERT



## R-Alert Quick Start Guide Personal Emergency Alert Device

Rev 0.1



Before operating this product, please read this quick-start guide to ensure proper use. Please store these instructions a safe place for future reference.

### FEATURES

- Small compact device
- Range 75' indoors, 300 ft outdoors
- Press for 2~4 Sec then release to activate
- Replaceable battery
- 6 month battery life
- Fall detection option
- Multi-Axis accelerometer

### GENERAL INFORMATION

1. Before installing and operating the unit, please read this manual carefully.
2. Range and battery life are approximate and depends on usage, features activated and environment. Bluetooth 4.0 technology allows for approximately 75ft indoors and 300ft outdoors between the R-alert button and the Smartphone.
3. The R-Alert button fall detection feature looks for approximately 3 feet of free-fall (~300ms) followed by an impact of at least 3g's.
4. Device supports Bluetooth® (BT4.0) profiles and must be paired with a functioning and Bluetooth® compatible phone that is running the Remote Alert Personal Security & Safety App with an active subscription
5. Bluetooth range varies depending on the structure where the device is used.
6. Make sure your phones location services are active and functioning properly
7. iPhone® is a registered trademark of Apple, Inc, Bluetooth is a registered trademark of Bluetooth SIG Inc, Android™ is a trademark of Google Inc, V.ALRT is a registered trademark of VSN Mobile Inc. This device includes copyrighted software. Laws in the United States and other countries protect VSN and /or its third party providers rights to the copyrighted software including the exclusive right to reproduce and distribute. No software on this device may be modified, reproduced, reversed engineered or distributed in any manner without express written permission.
8. Remote Alert LLC., reserves the right in its sole discretion to limit, disconnect or terminate your service in the event of abuse.

### APPLICATION

1. Download the Remote Alert Personal Security & Safety App from the appropriate app store, (Google Play for Android devices and Apple Store for iOS devices).
2. Search for the Remote Alert App ,download, install and sign up today.



### MAIN FUNCTION

#### Emergency Mode

Press button for 2~4 second then release to create an alarm condition



#### Fall Detection (When Enabled)



Once triggered the button will flash red/green.

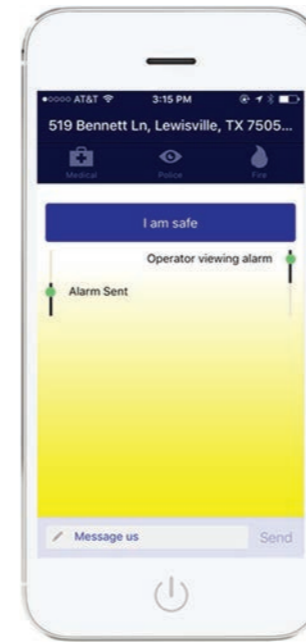

Once the button triggers an alarm in the app the central station will receive your GPS location, they will proceed to call you before dispatching the authorities.

### BASIC OPERATION

Once you download the Remote Alert Personal Security & Safety App complete the sign up process. (Refer to [www.remotealert.com](http://www.remotealert.com) for full details) Once complete go to the main menu and select "Manage devices" to add your R-Alert button so it is active within your app.

The Remote Alert app will need to be running on the phone but may be placed in the background so it is still operational.

To trigger an alarm press and hold the button for 2~4 seconds then release.

If you have fall detection enabled the multi- axis accelerometer will trigger an alarm when a fall is detected.

### ACTIVATING BUTTON

In order for the button to be recognized by the app so it is ready for programming you will first need to press and hold the button for 10 seconds. After 10 second you will here a short beep tone from the button. Now you can proceed to the next step, programming.

If you replace the battery you will also need to re-activate the button so it will be recognized by the app.



10 sec.

### PROGRAMMING

With the app open go to the menu by selecting the three horizontal lines in the upper left part of the screen, then select "Manage devices"

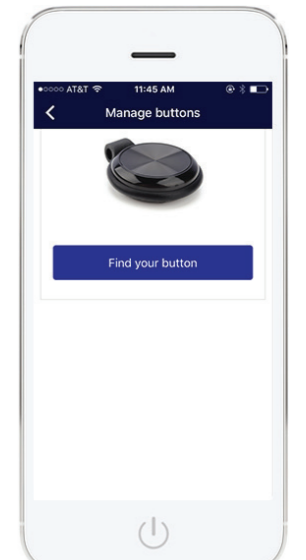
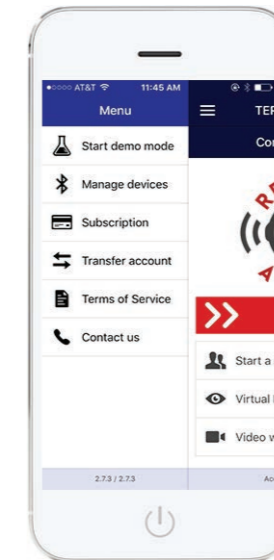

Select "Find your button"

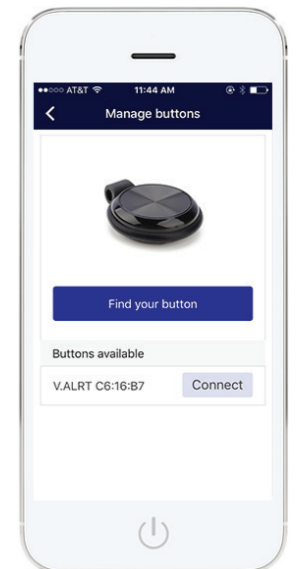
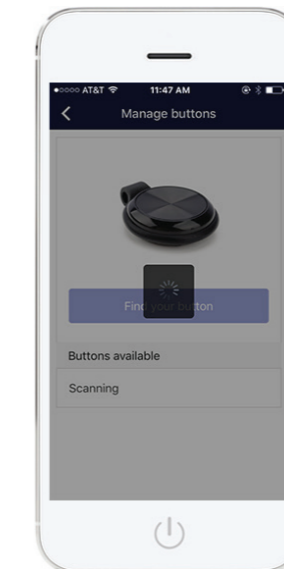

After the button is found select "Connect"

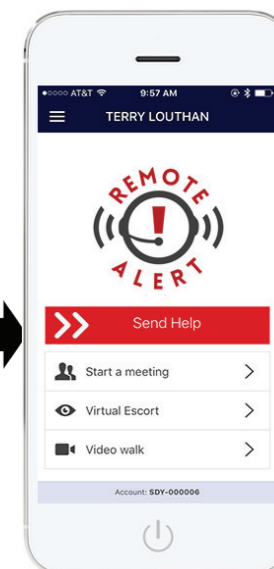
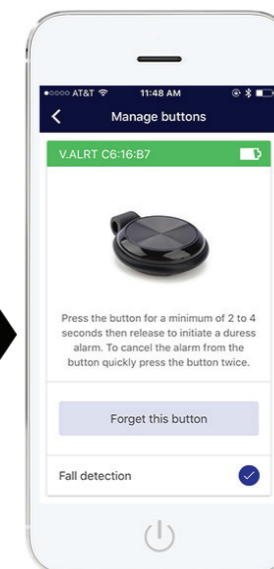
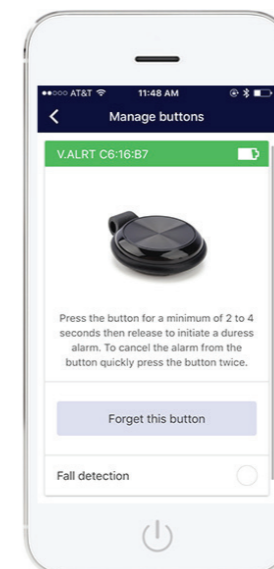

Once the button is active you can select "Fall detection" if that feature is required. When complete select the back arrow to exit to the main menu.

## DISCONNECTED

Your phone may receive a notification stating your button has been disconnected, this would normally occur if you are out of range of the button or possibly if the battery drained too low for the unit to work.

To reconnect move back within the range requirements or replace your battery, then re-activate the button.

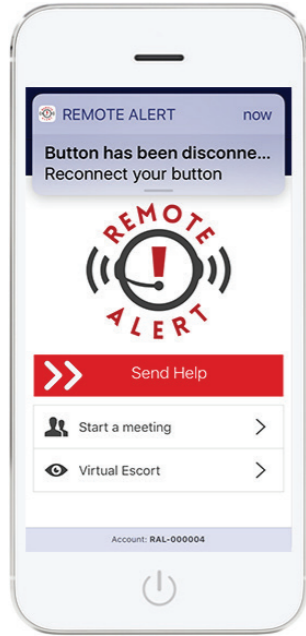

## WRIST BAND

WRIST BAND

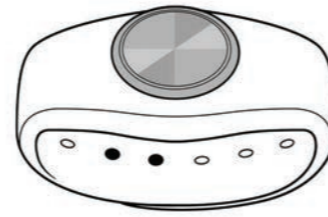

INSERTION

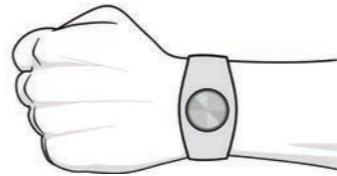
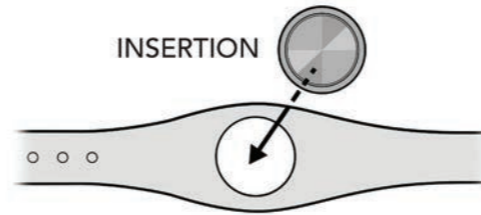

## OPTIONAL ACCESSORY

CLIP



INSERTION

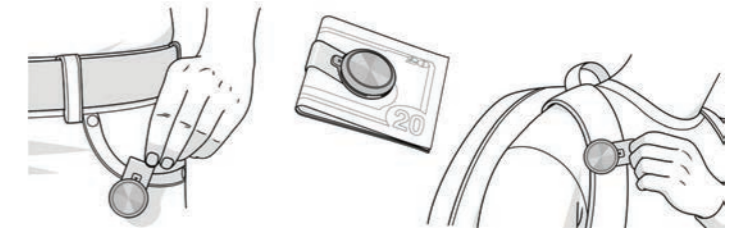
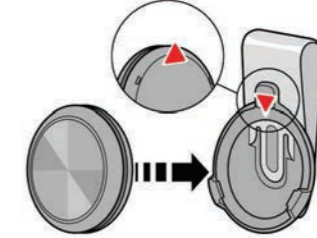

## PENDANT

PENDANT



INSERTION

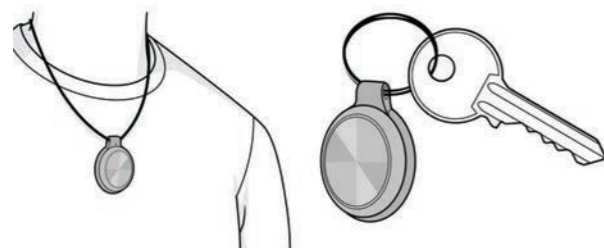
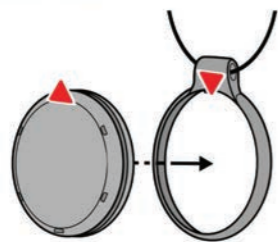

## BATTERY REPLACEMENT

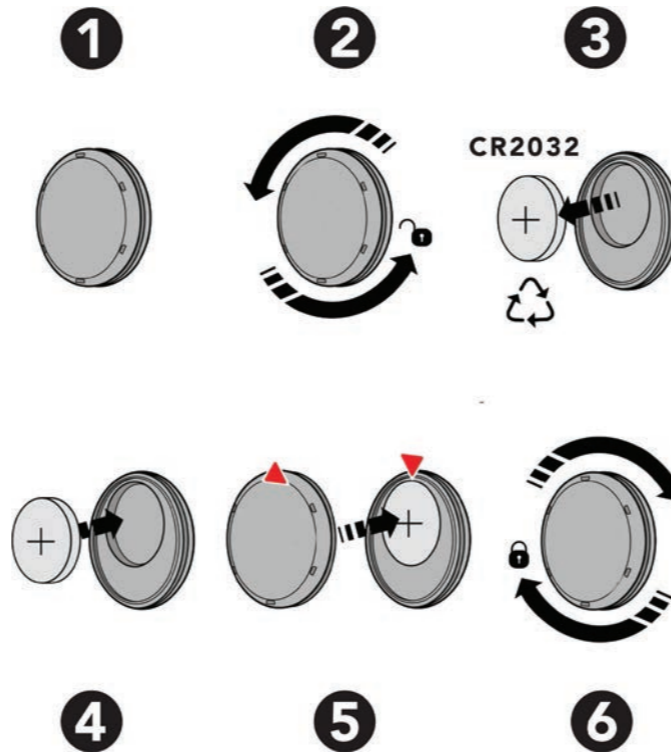

When replacing the battery make sure when you reassemble the two halves you tighten all the way so the button is sealed and waterproof. This ensures that the integrity of the IP64 rating is maintained.

\* After changing the battery make sure you reactivate the button so it will be recognized by app.

## SPECIFICATIONS

<b>Technology</b>		Bluetooth® 4.0
		Multi-Axis Accelerometer
<b>Range*</b>	Indoor	75'
	Outdoor	300'
<b>Physical</b>	Construction	Polycarbonate Shell
	Dimensions	1.3" diameter 0.4" thickness
	Weight	0.3 ounces
<b>Power*</b>	Battery	Replaceable CR2032
	Life	Approximate 6 months
<b>Environmental</b>	IP Rating	Weather Resistant IP64
<b>Order Codes</b>	R-Alert Kit	Kit consists of Button, Watch Band, Pendant
	R-Alert Belt Clip	Belt Clip
	R-Alert Lanyards	Lanyards for Pendant

Requires a compatible smart phone with active data plan running the Remote Alert Personal Security and Safety App - downloadable at the Apple or Google play app stores.

Note: Not for use in showers as humidity will damage electronics

Remote Alert  
519 Bennett Lane  
Suite 100  
Lewisville, Texas 75057  
214-960-4564

Please visit our website for full information: [www.remotealert.com](http://www.remotealert.com)  
Remote Alert LLC. reserves the right to amend specifications and design without prior notice